

# INSTRUCTIONS OF INSTALLATION FOR EXTERIOR DOORS

## **CAUTION!**

Before beginning installation, please check the technical state of the doors, functionality, way of opening and dimensions are in accordance with your order.

# CONDITIONS FOR PREPARING THE DOORS FOR INSTALLATION

## CHECK THE CONTENTS OF THE PROVIDED SET

### Included in the set:

- door leaf with seal
- door frame with seal
- threshold (with or without seal, depending on the door series)
- set of handles with covers and upper escutcheons
- cylinder lock, cylinder lock with knob
- installation openings covers
- hex key
- remaining ordered accessories as specified on the list

Check if supplied doors are in accordance with the order specification, and are in no way damaged or have constructional flaws. Check if door frame and door leaf have the correct way of opening (fig. 1). Check the colour.

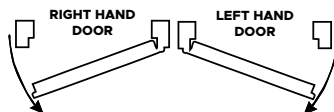

fig. 1

## DOORS WITH 9, 11, 12 STEEL FRAME INSTALLATION

### ASSEMBLING THE STEEL FRAME (FIG. 2)\*

- Prepare clean and level surface for assembling.
- Insert the upper element into the sides and bend attaching-clamping elements. First middle (1), next outer (2) threshold strips of the frame to be connected with sides with screws.

### DOOR INSTALLATION

- Be extra careful while unpacking the door to avoid any damage done to it.
- Fasten the aluminium threshold to the steel frame with 4 installation screws (fig. 3) paying attention to fit the threshold seal line with the door frame. Confirm the correctness of installation by measuring the outer width from the side of threshold and lintel.
- Fasten and secure the threshold with at least 3 screws on the side endangered with attack. Not further than 20 cm from the door frame.\*\*
- Flatten and clean surface of prepared opening in the wall.
- Insert the door frame with the threshold already attached into the mounting hole.
- Place the frame in the desired spot and fasten it in place with chocks. Check the frame's diagonals (+/- 2mm).
- It is recommended to install the door leaf now. Then check how it fits the door frame by monitoring gaps between door leaf and door frame.
- Check that the main frame is properly aligned horizontally and vertically. Check the angle between the upper beam and sides. It is recommended that the frame is mounted flush to the wall on which it is supposed to open. This way of installation minimises the risk of breaking the door leaf in an uncontrolled movement.
- Dampen the wall and door frame with water then fill the gaps with low pressure spray foam.

**Caution! Leave the chocks securing the horizontal and vertical alignment in while the foam is drying to prevent compromising movements.**

- Use chocks at the height of hinges and lock openings.
- Door frame should be fastened with 9 expansion dowels, appropriate to the surface in which it is installed.
- After finishing the work, insert the rubber seal into the aluminium threshold. Remove protective foil. Caulk the places where vertical and horizontal parts of the frame meet with silicone. Install locks, handles, escutcheons. If necessary, adjust the hinges and lock pressure.
- Doors with glazing require strengthened P4 glass.\*\*
- Doors are compliant with RC2 class only when main and additional locks are fully locked.\*\*

### HINGES INSTALLATION

- Unscrew the hinge from the frame (with a hex key, one full turn).
- Fully insert pressing plate - with a light strike.
- Turn the screw until gap is wide enough to insert the hinge.
- Fully insert the hinge and tighten the installation screw.
- Tighten the blocking screw (with a hex key) that prevents the hinge from being unscrewed\*\*

**Caution! Not inserting the pressing plate fully may cause the damage of the element fastening the hinge.**

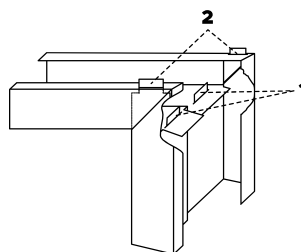

fig. 2

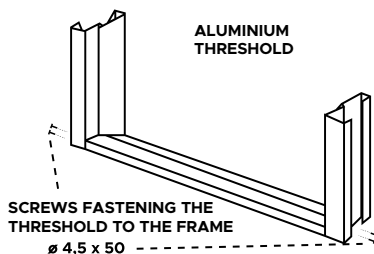

fig. 3

\*Does not apply to TERMO frame doors.

\*\*Applies only to RC2 burglar-proof doors.

\*\*\*Does not apply to NORMAL doors.

## DOORS WITH TERMO FRAME INSTALLATION

- Be extra careful while unpacking the door to avoid any damage done to it.
- Flatten and clean surface of prepared opening in the wall.
- Insert the door frame with the threshold already attached into the mounting hole.
- Fasten and secure the threshold with at least 3 screws on the side endangered with attack. Not further than 20 cm from the door frame.\*\*
- Place the frame in the desired spot and fasten it in place with chocks. Check the frame's diagonals (+/- 2mm).
- Check that the main frame is properly aligned horizontally and vertically. Check the angle between the upper beam and sides. It is recommended that the frame is mounted flush to the wall on which it is supposed to open. This way of installation minimises the risk of breaking the door leaf in an uncontrolled movement.
- Use chocks at the height of hinges and lock openings. The door frame should be fastened with 13 mounting anchors included in the set.
- The door frame should be installed with mounting dowels, not less than 4 (5 for Termo Prestige Lux doors) on lock side and hinges side. Distance from the end of the frame should not be more than 33 cm (28 cm for Termo Prestige Lux doors), distance between each dowel not greater than 73 cm (76 cm for Termo Prestige Lux doors)
- It is recommended to install the door leaf now. Then check how it fits the door frame by monitoring gaps between door leaf and door frame.
- If all of the gaps are equal in size, dampen the wall and door frame with water then fill the gaps with low pressure spray foam.
- **Caution! Leave the chocks securing the horizontal and vertical alignment in while the foam is drying to prevent compromising movements.**
- After finishing the work, insert the rubber seal into the aluminium threshold. Remove protective foil. Caulk the places where vertical and horizontal parts of the frame meet with silicone. Install locks, handles, escutcheons. If necessary, adjust the hinges and lock pressure.
- Fasten the door frame to the wall with at least 13 mounting anchors. 5 pcs. each for vertical parts. 3 pcs. for the upper part. 15 cm from the corners and so the distance between each was not greater than 50 cm. Install the anchors in the frame starting with the vertical part on hinges side. (fig. 4).
- After installing the door frame, clean all lock openings and remaining elements, removing any residue left from installation works. Install the handles or other accessories. If needed, adjust the hinges and lock.
- In order to verify the correct operation of not directly visible components, look underneath the door leaf to confirm if the falling seal correctly adjoins the threshold after closing the door. If not, at the hinges side of the door, adjust the seal pressing element. This adjustment applies to Termo Prestige Lux doors.
- Doors with glazing require strengthened P4 glass.\*\*

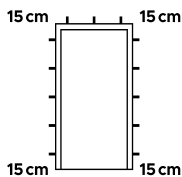

fig. 4

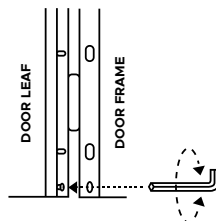

fig. 5

## ADJUSTMENT OF THE DOOR SETTING

### HINGES ADJUSTMENT (FIG. 6)\*\*\*

1. Horizontal adjustment (moving the door leaf left/right).
2. Vertical adjustment (moving the door leaf up/down).
3. Door leaf to door frame pressure of contact adjustment.
4. In TERMO frame doors, blocking screw should be inserted to the length of 18 mm\*\*\*.

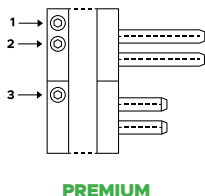
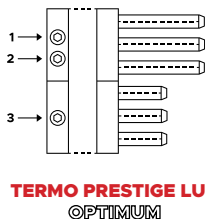

fig. 6

### ESPAÑOLETTE ADJUSTMENT

Adjusting door leaf to door frame pressure of contact is done by adjusting hex sockets in lock area of the door leaf (españolette) (fig. 7).

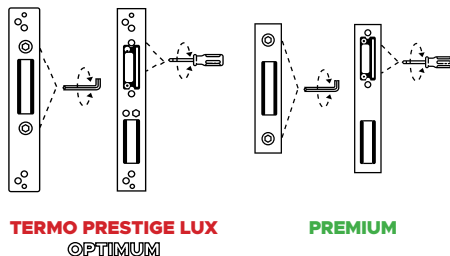

fig. 7